

In order to add **new** users and appartments to the VPS. locate your VP in the PAL GATE APP and press on the settings button.

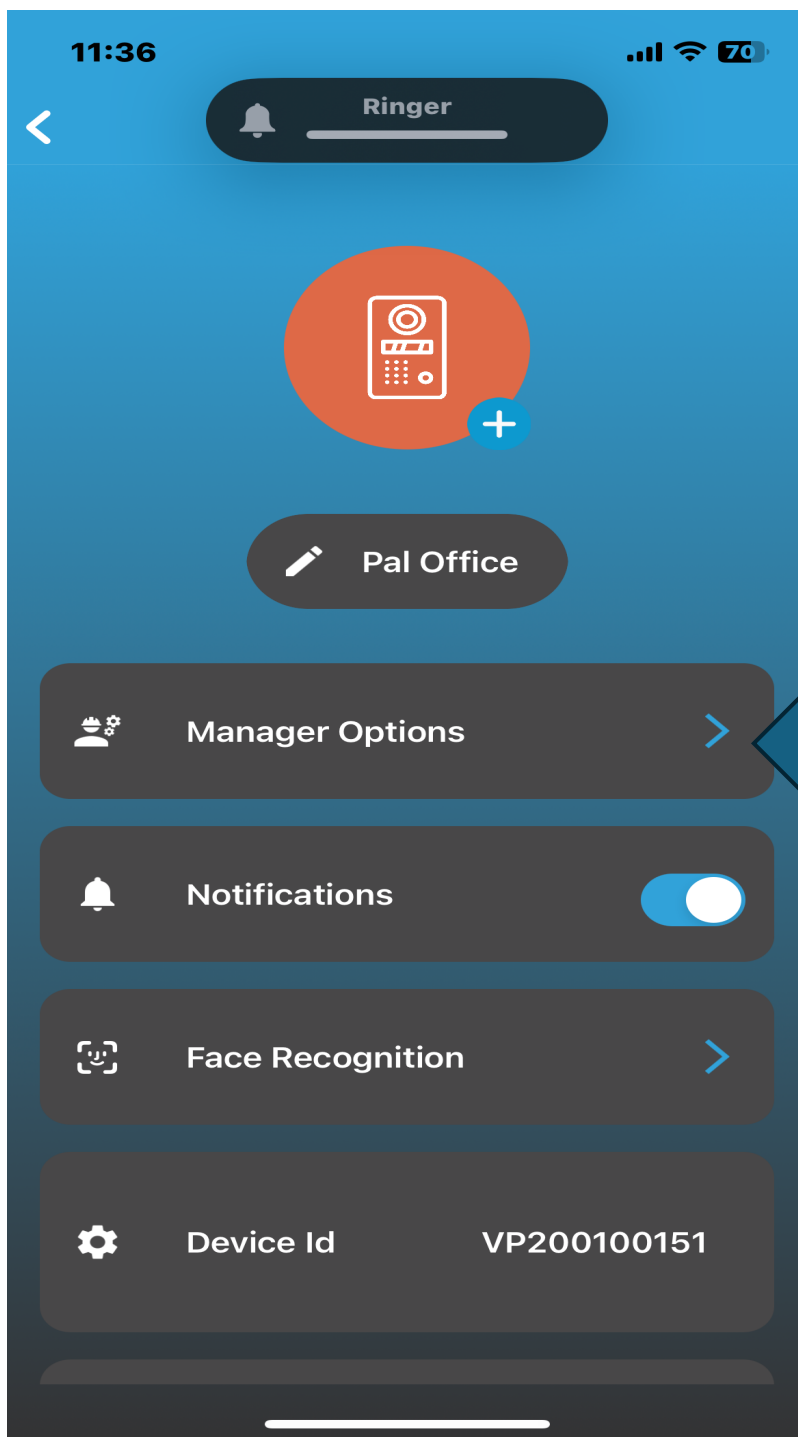

As the manager in the VPS you will be able to see the “Manager Options” button.

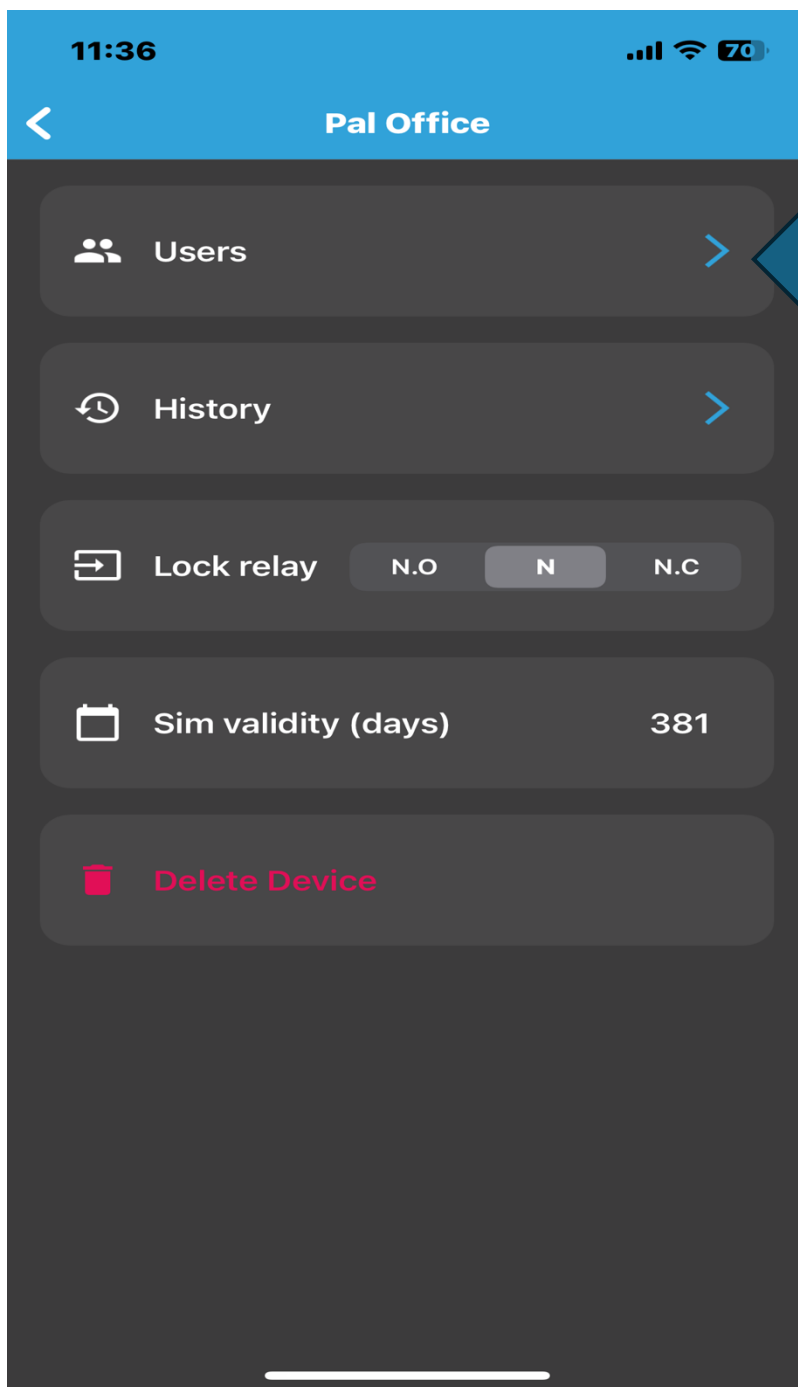

In order to manage the users press on “Users” button.

In order to view device history press “History” button.

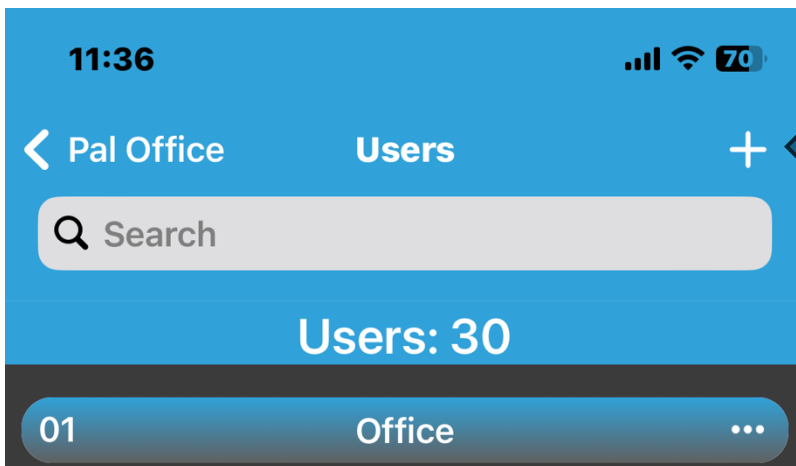

To add new users press the “ + “.

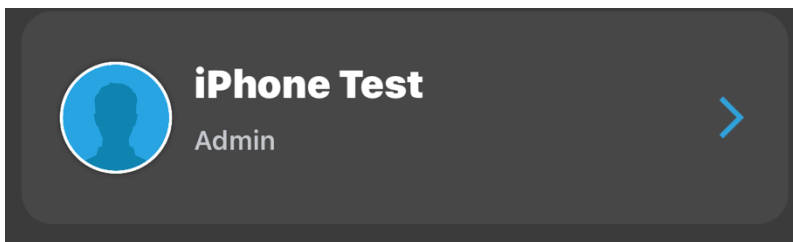

To manage existing users press on the user.

11:36

Users Add User Save

Name

+972 Phone number

User

Choose Call Group

Output 1

Latch Output 1

Output 2

Fill the user info.

Important! You must choose a “Call Group”

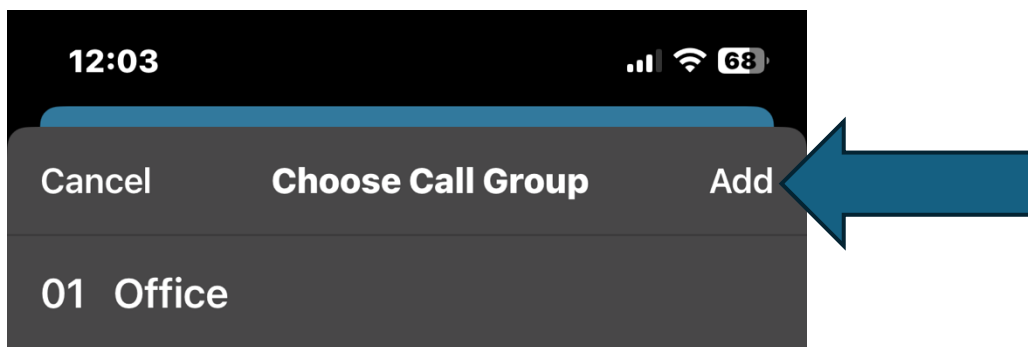

You can press on existing call group or add a new group.

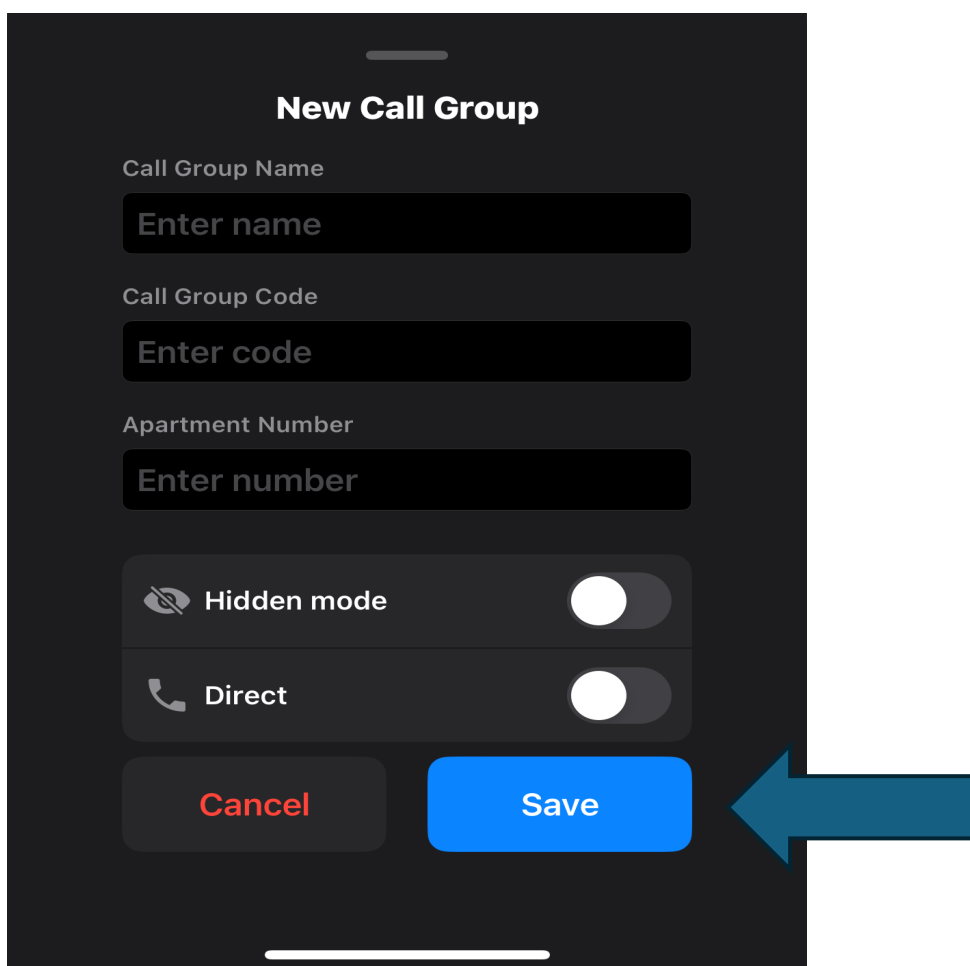

After filling the information press save!

Call group Name – the name of the group (Family name / Company name)

Call Group Code – code to open the VPS

Apartment Number – number of the apartment

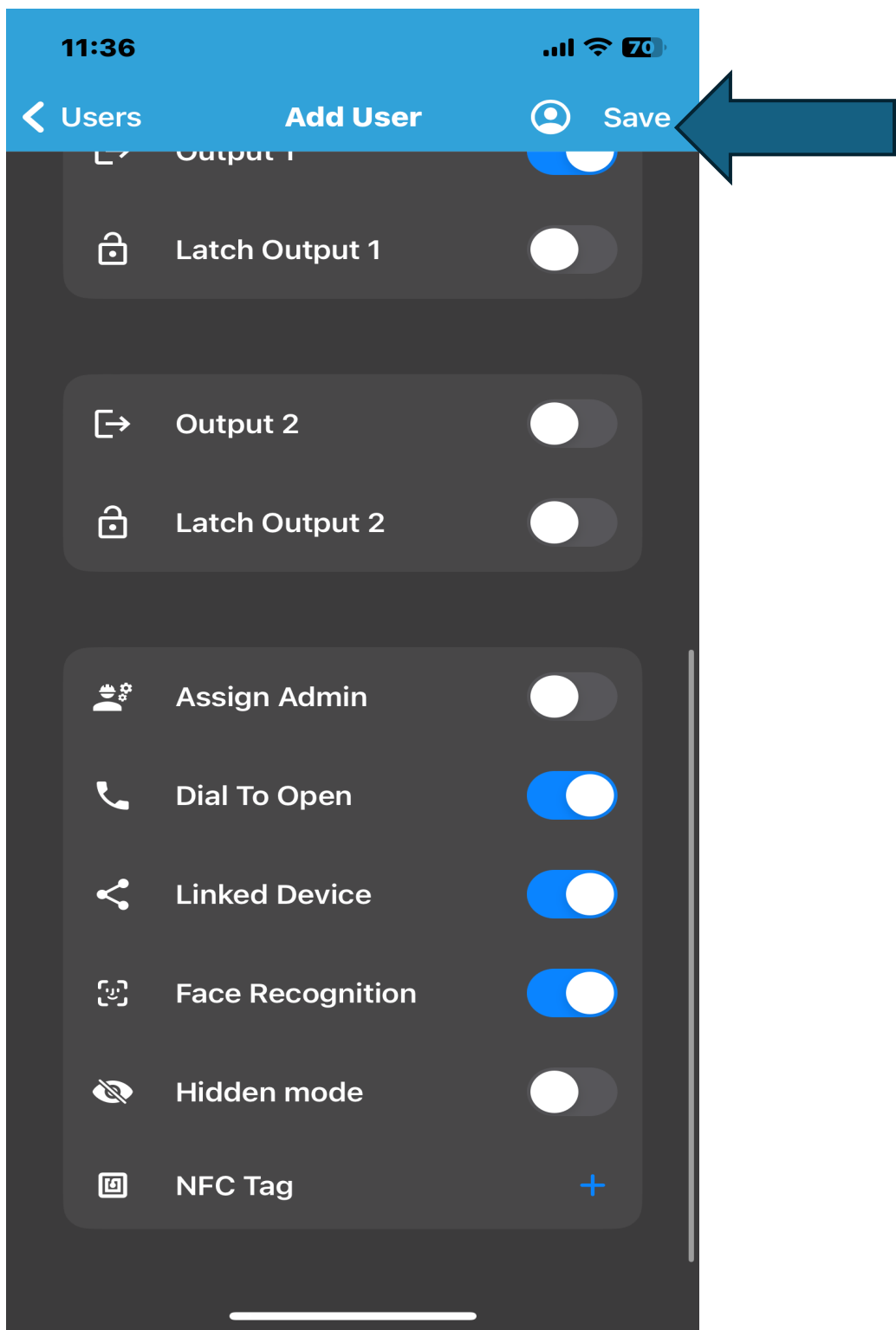

Important! Press save after filling all the info.