

## Smart Vehicle Detector VD900-433

### INTRODUCTION

VD 900-433 series is a new **wireless Vehicle Detector** featuring compact dimension, This innovative detector is Plug and play, all-in-one device that operates at a frequency range of 433MHz and is an ideal solution for vehicle detecting when depart a public or office parking.

It includes a web interfaces that makes it easy to install and use.

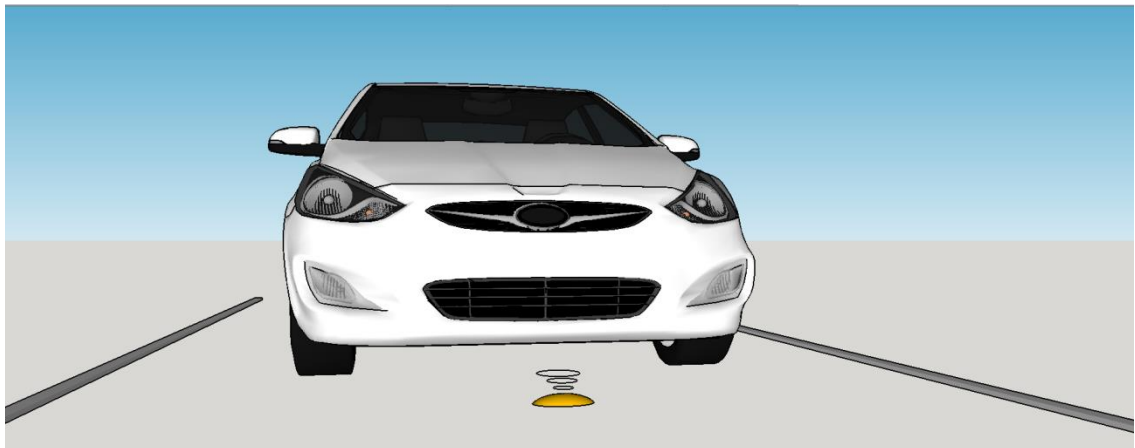

### Technical Specifications

Operating Frequency	433MHz ISM Band
Power Supply	Buttery DC 3.6 v
Dimensions	215mm × 125mm

### Applications

- Parking lot management.
- Vehicle access control

## Vehicle Detector Installation Instructions

### Before installation

- Remove 4 screws from bottom cover
- Open the bottom cover
- Connect the jumper to it's place.
- Close back the cover but very important to place the seal back to its place.



### Highlights

- Power provided by a battery which will last for approximately 5 years (1000 entrances per day).
- Holds approximately 1000 kg weight
- **WARNING: Not To Be Used for Personnel Protection**

1

Place the Vehicle detector at the center of rote on clean surface so vehicles will pass when it is beneath them

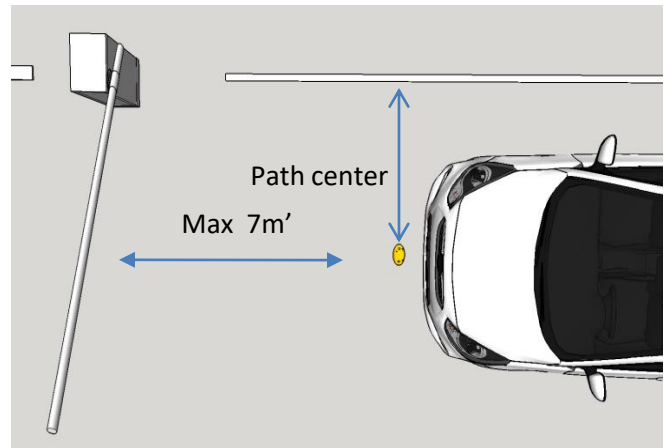

2

To activate the detector, use the magnet provided along with the detector. Put the magnet on the set-up point and wait for 3 beep sounds slowly and a final long sound. After the long sound remove the magnet at least 1 meter from the detector.

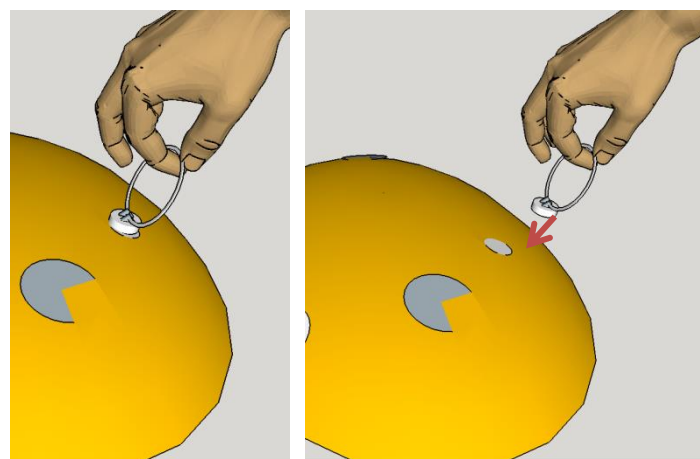

3

Preparations: Add the new detector to Pal SG303 –\*\*WR unit with RF technology such: GA-WRL, GA-WR, GB-WR, GI-WR. Enter the detector/s identification numbers.