

In order to enable **Face Recognition** for users to the VPS. locate your VP in the PAL GATE APP and press on the settings button.

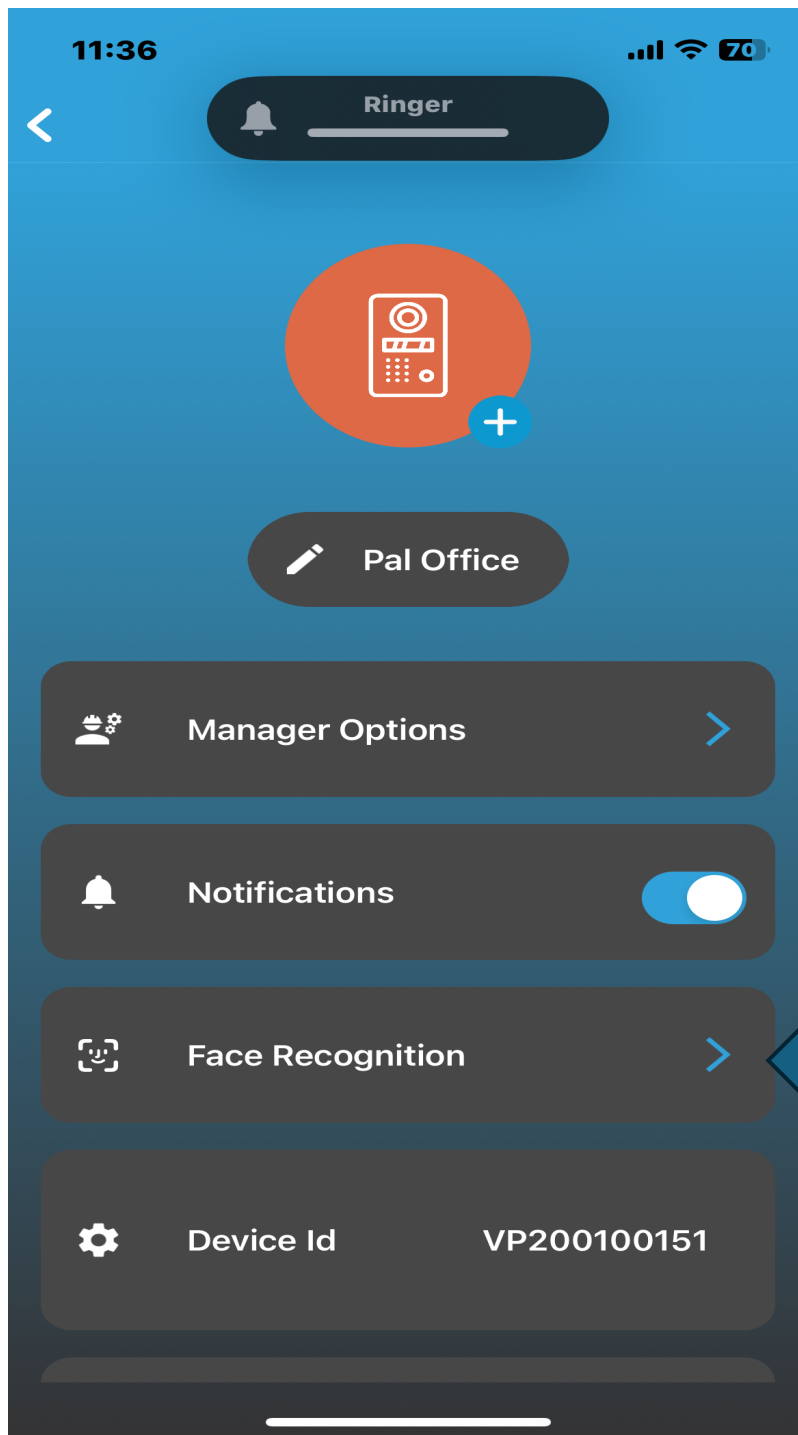

Press on the **"Face Recognition"**.

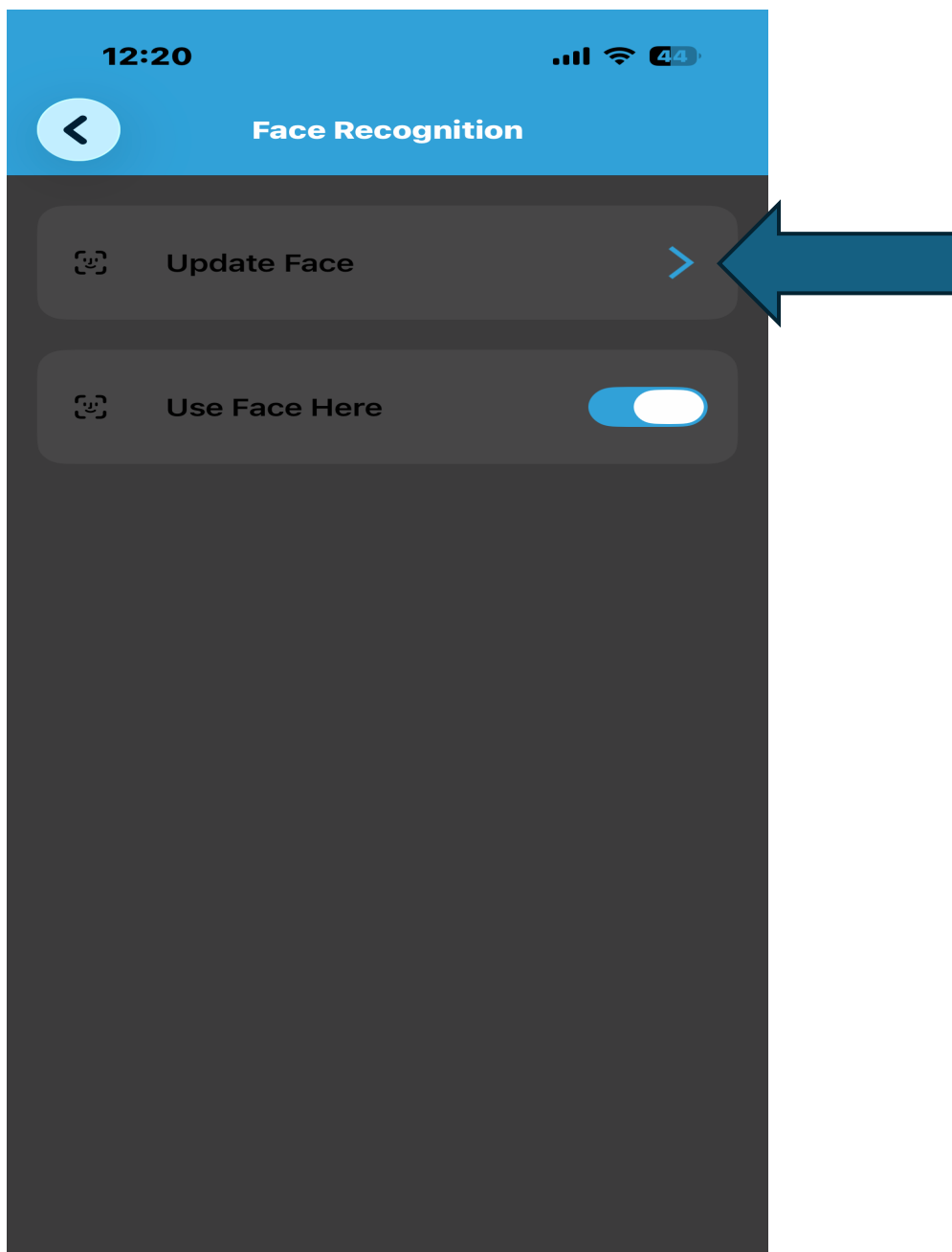

In order to manage the face press on “Update Face” button.

In order to enable **Face Recognition** in device press “Use Face Here” button.

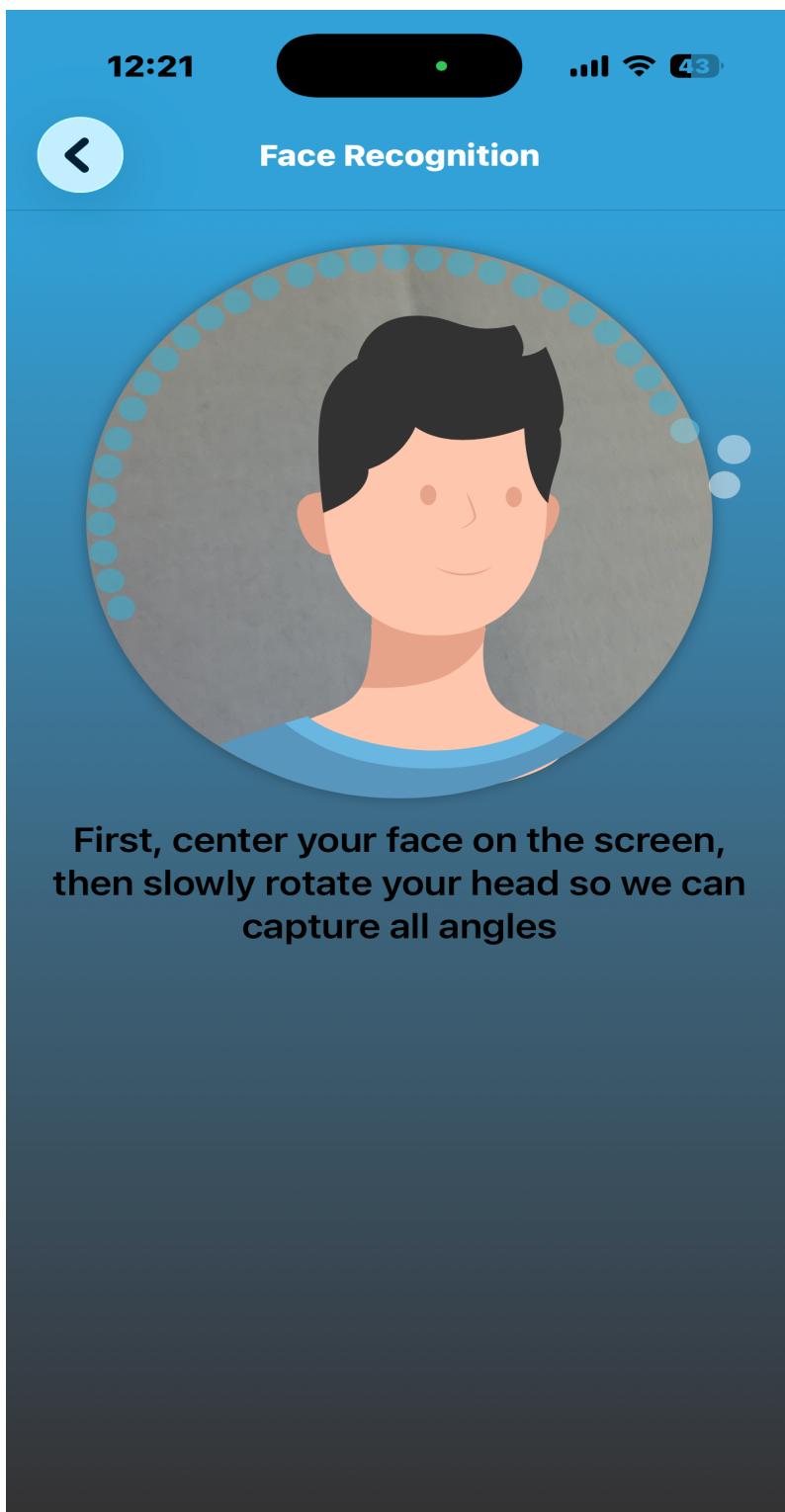

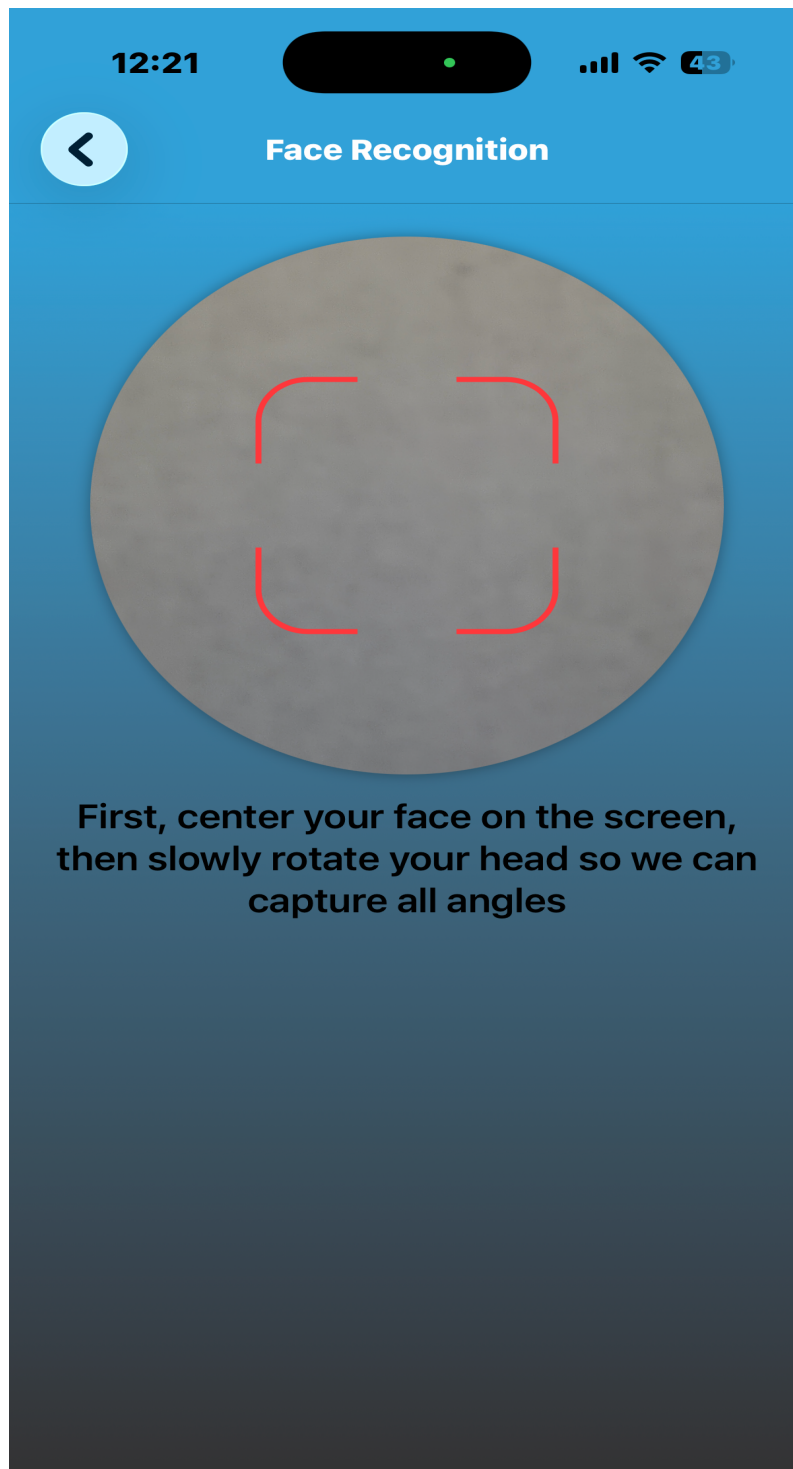

After doing the **Face Recognition** procedure the box would turn green.